

Seller disclosure statement



Queensland
Government

Property Law Act 2023 section 99

Form 2, Version 1 | Effective from: 1 August 2025

WARNING TO BUYER – This statement contains important legal and other information about the property offered for sale. You should read and satisfy yourself of the information in this statement before signing a contract. You are advised to seek legal advice before signing this form. You should not assume you can terminate the contract after signing if you are not satisfied with the information in this statement.

WARNING – You must be given this statement before you sign the contract for the sale of the property.

This statement does not include information about:

- » flooding or other natural hazard history
- » structural soundness of the building or pest infestation
- » current or historical use of the property
- » current or past building or development approvals for the property
- » limits imposed by planning laws on the use of the land
- » services that are or may be connected to the property
- » the presence of asbestos within buildings or improvements on the property.

You are encouraged to make your own inquiries about these matters before signing a contract. You may not be able to terminate the contract if these matters are discovered after you sign.

Part 1 – Seller and property details

Seller	Jonathan Jesse Mitchell
Property address (referred to as the “property” in this statement)	22 Pauls Road, Upper Caboolture QLD 4510
Lot on plan description	6 ON SP 179108

Community titles scheme
or BUGTA scheme:

Is the property part of a community titles scheme or a BUGTA scheme:

Yes

*If **Yes**, refer to Part 6 of this statement
for additional information*

No

*If **No**, please disregard Part 6 of this statement
as it does not need to be completed*

Part 2 – Title details, encumbrances and residential tenancy or rooming accommodation agreement

Title details	The seller gives or has given the buyer the following—
	A title search for the property issued under the <i>Land Title Act 1994</i> showing interests registered under that Act for the property. <input checked="" type="checkbox"/> Yes
	A copy of the plan of survey registered for the property. <input checked="" type="checkbox"/> Yes

Registered encumbrances	<p>Registered encumbrances, if any, are recorded on the title search, and may affect your use of the property. Examples include easements, statutory covenants, leases and mortgages.</p> <p>You should seek legal advice about your rights and obligations before signing the contract.</p>
Unregistered encumbrances (excluding statutory encumbrances)	<p>There are encumbrances not registered on the title that will continue <input type="checkbox"/> Yes <input checked="" type="checkbox"/> No to affect the property after settlement.</p> <p>Note—If the property is part of a community titles scheme or a BUGTA scheme it may be subject to and have the benefit of statutory easements that are NOT required to be disclosed.</p> <p>Unregistered lease (if applicable)</p> <p>If the unregistered encumbrance is an unregistered lease, the details of the agreement are as follows:</p> <ul style="list-style-type: none"> » the start and end day of the term of the lease: <input type="text"/> » the amount of rent and bond payable: <input type="text"/> » whether the lease has an option to renew: <input type="text"/> <p>Other unregistered agreement in writing (if applicable)</p> <p>If the unregistered encumbrance is created by an agreement in writing, and is not an unregistered lease, a copy of the agreement is given, together with relevant plans, if any. <input type="checkbox"/> Yes</p> <p>Unregistered oral agreement (if applicable)</p> <p>If the unregistered encumbrance is created by an oral agreement, and is not an unregistered lease, the details of the agreement are as follows:</p>
Statutory encumbrances	<p>There are statutory encumbrances that affect the property. <input checked="" type="checkbox"/> Yes <input type="checkbox"/> No</p> <p><i>If Yes, the details of any statutory encumbrances are as follows:</i></p>
Residential tenancy or rooming accommodation agreement	<p>The property has been subject to a residential tenancy agreement or a rooming accommodation agreement under the <i>Residential Tenancies and Rooming Accommodation Act 2008</i> during the last 12 months. <input type="checkbox"/> Yes <input checked="" type="checkbox"/> No</p> <p>If Yes, when was the rent for the premises or each of the residents' rooms last increased? (<i>Insert date of the most recent rent increase for the premises or rooms</i>) <input type="text"/></p> <p>Note—Under the <i>Residential Tenancies and Rooming Accommodation Act 2008</i> the rent for a residential premises may not be increased earlier than 12 months after the last rent increase for the premises.</p> <p>As the owner of the property, you may need to provide evidence of the day of the last rent increase. You should ask the seller to provide this evidence to you prior to settlement.</p>

Part 3 – Land use, planning and environment

WARNING TO BUYER – You may not have any rights if the current or proposed use of the property is not lawful under the local planning scheme. You can obtain further information about any planning and development restrictions applicable to the lot, including in relation to short-term letting, from the relevant local government.

Zoning	The zoning of the property is (<i>Insert zoning under the planning scheme, the Economic Development Act 2012; the Integrated Resort Development Act 1987; the Mixed Use Development Act 1993; the State Development and Public Works Organisation Act 1971 or the Sanctuary Cove Resort Act 1985, as applicable</i>):		
	GENERAL RESIDENTIAL		
Transport proposals and resumptions	The lot is affected by a notice issued by a Commonwealth, State or local government entity and given to the seller about a transport infrastructure proposal* to: locate transport infrastructure on the property; or alter the dimensions of the property.	<input type="checkbox"/> Yes	<input checked="" type="checkbox"/> No
	The lot is affected by a notice of intention to resume the property or any part of the property.	<input type="checkbox"/> Yes	<input checked="" type="checkbox"/> No
	<i>If Yes, a copy of the notice, order, proposal or correspondence must be given by the seller.</i>		
* <i>Transport infrastructure</i> has the meaning defined in the <i>Transport Infrastructure Act 1994</i> . A <i>proposal</i> means a resolution or adoption by some official process to establish plans or options that will physically affect the property.			
Contamination and environmental protection	The property is recorded on the Environmental Management Register or the Contaminated Land Register under the <i>Environmental Protection Act 1994</i> .	<input type="checkbox"/> Yes	<input checked="" type="checkbox"/> No
	The following notices are, or have been, given:		
	A notice under section 408(2) of the <i>Environmental Protection Act 1994</i> (for example, land is contaminated, show cause notice, requirement for site investigation, clean up notice or site management plan).	<input type="checkbox"/> Yes	<input checked="" type="checkbox"/> No
	A notice under section 369C(2) of the <i>Environmental Protection Act 1994</i> (the property is a place or business to which an environmental enforcement order applies).	<input type="checkbox"/> Yes	<input checked="" type="checkbox"/> No
	A notice under section 347(2) of the <i>Environmental Protection Act 1994</i> (the property is a place or business to which a prescribed transitional environmental program applies).	<input type="checkbox"/> Yes	<input checked="" type="checkbox"/> No
Trees	There is a tree order or application under the <i>Neighbourhood Disputes (Dividing Fences and Trees) Act 2011</i> affecting the property.	<input type="checkbox"/> Yes	<input checked="" type="checkbox"/> No
	<i>If Yes, a copy of the order or application must be given by the seller.</i>		
Heritage	The property is affected by the <i>Queensland Heritage Act 1992</i> or is included in the World Heritage List under the <i>Environment Protection and Biodiversity Conservation Act 1999</i> (Cwlth).	<input type="checkbox"/> Yes	<input checked="" type="checkbox"/> No
Flooding	Information about whether the property is affected by flooding or another natural hazard or within a natural hazard overlay can be obtained from the relevant local government and you should make your own enquires. Flood information for the property may also be available at the FloodCheck Queensland portal or the Australian Flood Risk Information portal.		
Vegetation, habitats and protected plants	Information about vegetation clearing, koala habitats and other restrictions on development of the land that may apply can be obtained from the relevant State government agency.		

Part 4 – Buildings and structures

WARNING TO BUYER – The seller does not warrant the structural soundness of the buildings or improvements on the property, or that the buildings on the property have the required approval, or that there is no pest infestation affecting the property. You should engage a licensed building inspector or an appropriately qualified engineer, builder or pest inspector to inspect the property and provide a report and also undertake searches to determine whether buildings and improvements on the property have the required approvals.

Swimming pool	There is a relevant pool for the property.	<input type="checkbox"/> Yes	<input checked="" type="checkbox"/> No
	If a community titles scheme or a BUGTA scheme – a shared pool is located in the scheme.	<input type="checkbox"/> Yes	<input checked="" type="checkbox"/> No
	Pool compliance certificate is given.	<input type="checkbox"/> Yes	<input checked="" type="checkbox"/> No
	OR Notice of no pool safety certificate is given.	<input type="checkbox"/> Yes	<input checked="" type="checkbox"/> No
Unlicensed building work under owner builder permit	Building work was carried out on the property under an owner builder permit in the last 6 years.	<input type="checkbox"/> Yes	<input checked="" type="checkbox"/> No
	<i>A notice under section 47 of the Queensland Building and Construction Commission Act 1991 must be given by the seller and you may be required to sign the notice and return it to the seller prior to signing the contract.</i>		
Notices and orders	There is an unsatisfied show cause notice or enforcement notice under the <i>Building Act 1975</i> , section 246AG, 247 or 248 or under the <i>Planning Act 2016</i> , section 167 or 168.	<input type="checkbox"/> Yes	<input checked="" type="checkbox"/> No
	The seller has been given a notice or order, that remains in effect, from a local, State or Commonwealth government, a court or tribunal, or other competent authority, requiring work to be done or money to be spent in relation to the property. <i>If Yes, a copy of the notice or order must be given by the seller.</i>	<input type="checkbox"/> Yes	<input checked="" type="checkbox"/> No
Building Energy Efficiency Certificate	If the property is a commercial office building of more than 1,000m ² , a Building Energy Efficiency Certificate is available on the Building Energy Efficiency Register.		
Asbestos	The seller does not warrant whether asbestos is present within buildings or improvements on the property. Buildings or improvements built before 1990 may contain asbestos. Asbestos containing materials (ACM) may have been used up until the early 2000s. Asbestos or ACM may become dangerous when damaged, disturbed, or deteriorating. Information about asbestos is available at the Queensland Government Asbestos Website (asbestos.qld.gov.au) including common locations of asbestos and other practical guidance for homeowners.		

Part 5 – Rates and services

WARNING TO BUYER – The amount of charges imposed on you may be different to the amount imposed on the seller.

Rates

Whichever of the following applies—

The total amount payable* for all rates and charges (without any discount) for the property as stated in the most recent rate notice is:

Amount: Date Range:

OR

The property is currently a rates exempt lot.**

OR

The property is not rates exempt but no separate assessment of rates
is issued by a local government for the property.

*Concessions: A local government may grant a concession for rates. The concession will not pass to you as buyer unless you meet the criteria in section 120 of the *Local Government Regulation 2012* or section 112 of the *City of Brisbane Regulation 2012*.

** An exemption for rates applies to particular entities. The exemption will not pass to you as buyer unless you meet the criteria in section 93 of the *Local Government Act 2009* or section 95 of the *City of Brisbane Act 2010*.

Water

Whichever of the following applies—

The total amount payable as charges for water services for the property as indicated in the most recent water services notice* is:

Amount: Date Range:

OR

There is no separate water services notice issued for the lot; however, an estimate of the total amount payable for water services is:

Amount: Date Range:

* A water services notices means a notice of water charges issued by a water service provider under the *Water Supply (Safety and Reliability) Act 2008*.

Part 6 – Community titles schemes and BUGTA schemes

(If the property is part of a community titles scheme or a BUGTA scheme this Part must be completed)

WARNING TO BUYER – If the property is part of a community titles scheme or a BUGTA scheme and you purchase the property, you will become a member of the body corporate for the scheme with the right to participate in significant decisions about the scheme and you will be required to pay contributions towards the body corporate’s expenses in managing the scheme. You will also be required to comply with the by-laws. By-laws will regulate your use of common property and the lot.

For more information about living in a body corporate and your rights and obligations, contact the Office of the Commissioner for Body Corporate and Community Management.

Body Corporate and Community Management Act 1997	The property is included in a community titles scheme. <i>(If Yes, complete the information below)</i>	<input type="checkbox"/> Yes	<input checked="" type="checkbox"/> No
Community Management Statement	<p>A copy of the most recent community management statement for the scheme as recorded under the <i>Land Title Act 1994</i> or another Act is given to the buyer.</p> <p>Note—If the property is part of a community titles scheme, the community management statement for the scheme contains important information about the rights and obligations of owners of lots in the scheme including matters such as lot entitlements, by-laws and exclusive use areas.</p>	<input type="checkbox"/> Yes	
Body Corporate Certificate	<p>A copy of a body corporate certificate for the lot under the <i>Body Corporate and Community Management Act 1997</i>, section 205(4) is given to the buyer.</p> <p><i>If No</i>— An explanatory statement is given to the buyer that states:</p> <ul style="list-style-type: none"> » a copy of a body corporate certificate for the lot is not attached; and » the reasons under section 6 of the <i>Property Law Regulation 2024</i> why the seller has not been able to obtain a copy of the body corporate certificate for the lot. 	<input type="checkbox"/> Yes	<input checked="" type="checkbox"/> No
Statutory Warranties	<p>Statutory Warranties—If you enter into a contract, you will have implied warranties under the <i>Body Corporate and Community Management Act 1997</i> relating to matters such as latent or patent defects in common property or body corporate assets; any actual, expected or contingent financial liabilities that are not part of the normal operating costs; and any circumstances in relation to the affairs of the body corporate that will materially prejudice you as owner of the property. There will be further disclosure about warranties in the contract.</p>		
Building Units and Group Titles Act 1980	The property is included in a BUGTA scheme <i>(If Yes, complete the information below)</i>	<input type="checkbox"/> Yes	<input checked="" type="checkbox"/> No
Body Corporate Certificate	<p>A copy of a body corporate certificate for the lot under the <i>Building Units and Group Titles Act 1980</i>, section 40AA(1) is given to the buyer.</p> <p><i>If No</i>— An explanatory statement is given to the buyer that states:</p> <ul style="list-style-type: none"> » a copy of a body corporate certificate for the lot is not attached; and » the reasons under section 7 of the <i>Property Law Regulation 2024</i> why the seller has not been able to obtain a copy of the body corporate certificate for the lot. <p>Note—If the property is part of a BUGTA scheme, you will be subject to by-laws approved by the body corporate and other by-laws that regulate your use of the property and common property.</p>	<input type="checkbox"/> Yes	<input checked="" type="checkbox"/> No

Signatures – SELLER



Jonathan.Jesse.Mitchell@Ap9.92.0202.6618438658161M10

Signature of seller

Signature of seller

Jonathan Jesse Mitchell

Name of seller

Name of seller

Apr 9, 2026

Date

Date

Signatures – BUYER

By signing this disclosure statement the buyer acknowledges receipt of this disclosure statement before entering into a contract with the seller for the sale of the lot.

Signature of buyer

Signature of buyer

Name of buyer

Name of buyer

Date

Date

Queensland Titles Registry Pty Ltd
ABN 23 648 568 101

Title Reference: 50570323	Search Date: 01/04/2026 14:51
Date Title Created: 31/08/2005	Request No: 55637092
Previous Title: 15643053	

ESTATE AND LAND

Estate in Fee Simple

LOT 6 SURVEY PLAN 179108

Local Government: MORETON BAY

REGISTERED OWNER

Dealing No: 718739912 11/05/2018

JONATHAN JESSE MITCHELL

EASEMENTS, ENCUMBRANCES AND INTERESTS

1. Rights and interests reserved to the Crown by
Deed of Grant No. 10478238 (POR 36)
2. MORTGAGE No 718739913 11/05/2018 at 09:26
NATIONAL AUSTRALIA BANK LIMITED A.C.N. 004 044 937

ADMINISTRATIVE ADVICES

NIL

UNREGISTERED DEALINGS

NIL

Caution - Charges do not necessarily appear in order of priority

** End of Current Title Search **

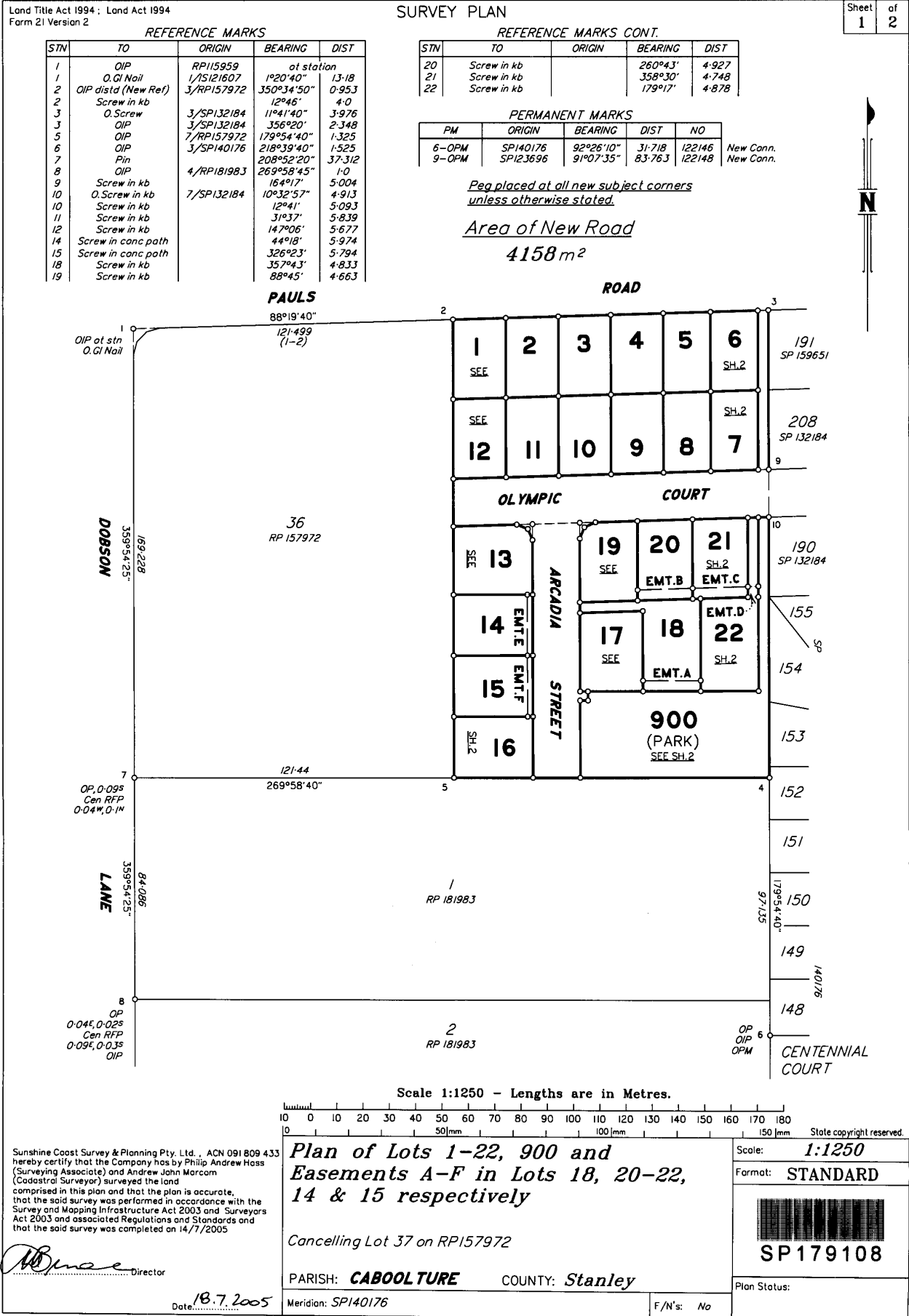

**WARNING : Folded or Mutilated Plans will not be accepted.
Plans may be rolled.
Information may not be placed in the outer margins.**

708919267

GC 400 NT

\$1759.75
24/08/2005 09:31

Registered

5. Lodged by

(Include address, phone number, reference, and Lodger Code)

1. Certificate of Registered Owners or Lessees.

I/We EXCHEQUER PROPERTY FINANCE P.T.Y. LTD. ACN 074 305 178
TRUSTEE UNDER INSTRUMENT 706826834

(Names in full)

* as Registered Owners of this land agree to this plan and dedicate the Public Use Land as shown hereon in accordance with Section 50 of the Land Title Act 1994.

* as Lessees of this land agree to this plan.

Bgerhead
Signature of *Registered Owners *Lessees
Sale Director
Exchequer Property Finance Pty Ltd.

* Rule out whichever is inapplicable

2. Local Government Approval.

* CABOOLTURE SHIRE COUNCIL
hereby approves this plan in accordance with the :
% Integrated Planning Act 1997

Dated this Twelfth day of August 2005

[Signature] # Delegated Officer

[Signature] #

* Insert the name of the Local Government. % Insert Integrated Planning Act 1997 or # Insert designation of signatory or delegation Local Government (Planning & Environment) Act 1990

3. Plans with Community Management Statement :

CMS Number :
Name :

4. References :

Dept File :
Local Govt : RAL-2003-2945
Surveyor : 2783-00

6. Existing

Title Reference	Lot	Plan
15643053	37	RP157972

Created

Lots	Emts	Road
1-22 & 900	A-F	New Rd

MORTGAGE ALLOCATIONS

Mortgage	Lots Fully Encumbered	Lots Partially Encumbered
706826839	1-22 & 900	-

Emt.C on RP192988 is to be extinguished prior to lodgement of plan.

1-22 & 900	POR. 36
Lots	Orig

7. Portion Allocation :

8. Map Reference :
9443-11324

9. Locality :
UPPER CABOOLTURE

10. Local Government :
CABOOLTURE S. C.

11. Passed & Endorsed :
Sunshine Coast Survey & Planning
By: Pty. Ltd. ACN 091 809 433
Date: 18.7.2005
Signed: *[Signature]*
Designation: Cadastral Surveyor

12. Building Format Plans only.

I certify that :
* As far as it is practical to determine, no part of the building shown on this plan encroaches onto adjoining lots or road.
* Part of the building shown on this plan encroaches onto adjoining * lots and road

Licensed Surveyor/Director * Date
* delete words not required

13. Lodgement Fees :

Survey Deposit \$
Lodgement \$
..... New Titles \$
Photocopy \$
Postage \$
TOTAL \$

14. Insert Plan Number
SP179108

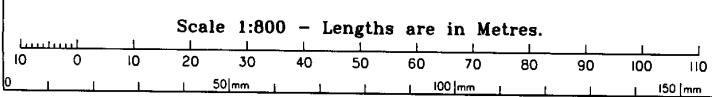
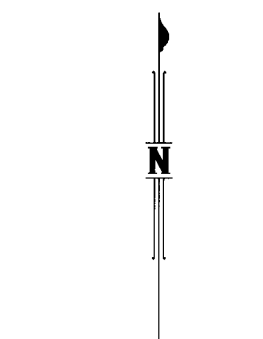
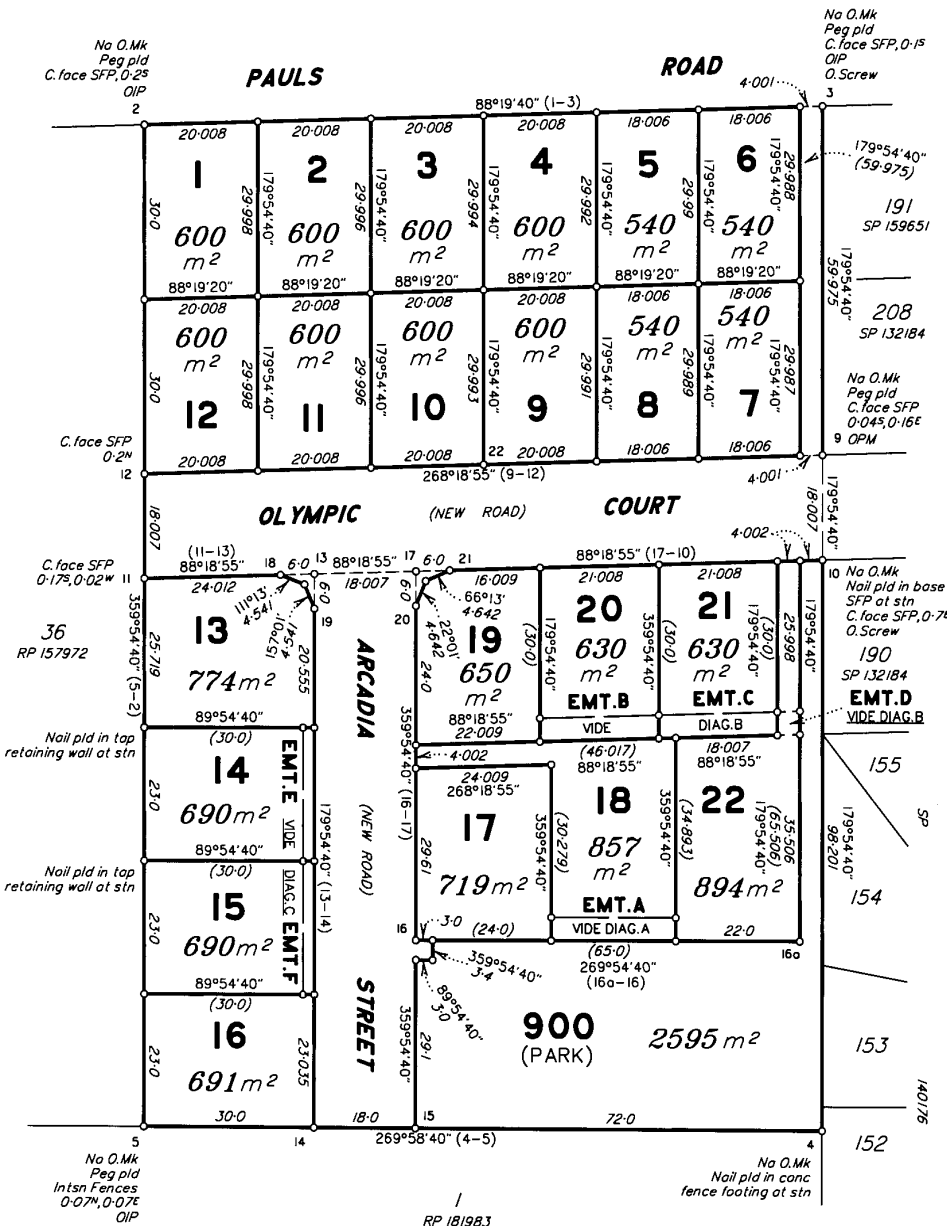
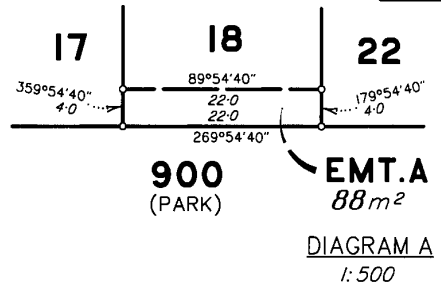
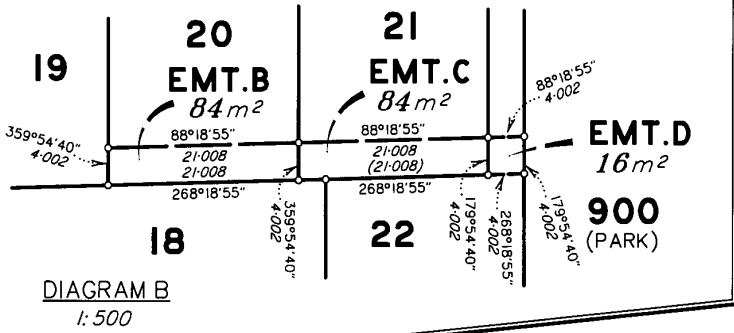

Search Results

1 result found.

Sheep Station Creek Environmental Park Nairn Rd	Upper Caboolture, QLD, Australia	(Included place before RNE closed, Record for reference only, no statutory basis) Register of the National Estate (Non-statutory archive)
---	-------------------------------------	---

Report Produced: Wed Apr 1 15:50:59 2026



Queensland Heritage Act 1992
Section 33(1)(b) Certificate of Affect

Certificate number:	COA-001099	Result number	1 of 1
Date of issue:	01-Apr-2026	Receipt No:	6972195
Client Reference			
Requested by:	InfoTrack Pty Ltd InfoTrack Pty Ltd PO Box 10314 Adelaide St PO Box 10314 Adelaide St Brisbane QLD 4000 qldsearching@infotrack.com.au 0730404010		

This is a certificate issued under section 33(1)(b) of the *Queensland Heritage Act 1992* (Heritage Act) as to whether a place or area is affected by: entry in the Queensland Heritage Register (QHR) as a State heritage place or protected area, a heritage agreement, a current QHR application, or is excluded from entry in the QHR.

RESULT

This response certifies that the place identified as:

Place Ref: None

Place Name: None

Lot: 6 Plan: SP179108

Located at:

is neither on the QHR nor the subject of a QHR application under the Heritage Act.

ADDITIONAL ADVICE

Note: This certificate is valid at the date of issue only

If you have any queries in relation to this search, please contact the Planning and Heritage Branch on 13 QGOV (137 468) or heritage@detsi.qld.gov.au.

Issued by the Chief Executive's delegate under the *Queensland Heritage Act 1992*



Department of the Environment, Tourism, Science and Innovation (DETSI)
ABN 46 640 294 485
GPO Box 2454, Brisbane QLD 4001, AUSTRALIA
www.detsi.qld.gov.au

SEARCH RESPONSE
ENVIRONMENTAL MANAGEMENT REGISTER (EMR)
CONTAMINATED LAND REGISTER (CLR)

InfoTrack Pty Ltd
PO Box 10314 Adelaide St
Brisbane QLD 4000

Transaction ID: 51136410 EMR Site Id: 01 April 2026
Cheque Number:
Client Reference:

This response relates to a search request received for the site:

Lot: 6 Plan: SP179108
22 PAULS RD
UPPER CABOOLTURE

EMR RESULT

The above site is NOT included on the Environmental Management Register.

CLR RESULT

The above site is NOT included on the Contaminated Land Register.

ADDITIONAL ADVICE

All search responses include particulars of land listed in the EMR/CLR when the search was generated.
The EMR/CLR does NOT include:-

1. land which is contaminated land (or a complete list of contamination) if DETSI has not been notified
2. land on which a notifiable activity is being or has been undertaken (or a complete list of activities) if DETSI has not been notified

If you have any queries in relation to this search please email emr.clr.registry@detsi.qld.gov.au

Administering Authority



Department of Transport and Main Roads

Property Search - Advice to Applicant

Property Search reference 1005039

Date: 01/04/2026

Search Request reference: 190650465

Applicant details

Applicant: Zenab Khalil

zenab@kolegal.com.au

Buyer: x x

Search response:

Your request for a property search on Lot 6 on Plan SP179108 at 22 Pauls Rd, Upper Caboolture Qld 4510 has been processed.

At this point in time the Department of Transport and Main Roads has no land requirement from the specified property.

Note:

1. Development proposed on this property may require approval under the Planning Act. This may include referral to the State Assessment and Referral Agency for assessment of the impacts to state transport corridors and infrastructure.
2. New or changed access between this property and a state transport corridor will require approval under the Transport Infrastructure Act.
3. To see what other State Government planning has been identified in your area, please refer to the online DA Mapping system. Refer to the State Transport interests under the SARA layers to identify what interests TMR has in your locality.
< <https://planning.dsdmip.qld.gov.au/maps/sara-da>>
4. Any properties located in proximity to a current or future State transport corridor may be affected by noise. For existing corridors, refer to the online SPP interactive mapping system. Select the Information Purposes and refer to the Transport Infrastructure. If the property is located in a mandatory transport noise corridor then Mandatory Part 4.4 of the Queensland Development Code will apply.
< <https://planning.dsdmip.qld.gov.au/maps/spp>>

Disclaimer:

Any information supplied by this Department of Transport and Main Roads' (TMR) property search is provided on the basis that you will use your own judgement to independently evaluate, assess and verify the information's completeness, suitability, purpose and usefulness.

Without limitation, TMR is under no liability for any negligence, claim, loss or damage (including consequential or indirect loss or lost time, profits, savings, contracts, revenue, interest, business opportunities, goodwill or damage to reputation) however caused (whether by negligence or otherwise) that may be suffered or incurred or that may arise directly or indirectly out of any act or omission on its part in connection with the use and reliance upon, and the provision of this property search, including loss or damage caused by any delays in providing this property search to the party who requested the information or any errors, misdescriptions, incompleteness and inaccuracies in the information. TMR excludes all warranties, representations, terms, conditions and undertaking in respect of the completeness, quality, accuracy, suitability or fitness of the information contained in this property search for your purpose. You acknowledge that the information provided is indicative only and may be subject to change.

Privacy Statement:

The personal information collected on this property search is required to enable TMR to communicate with you regarding your enquiry. The information recorded will not be disclosed to a third party without your consent or unless required or authorised to do so by law.

UNITYWATER BYDA MAP

Sequence Number: 270697701

Job Number: 52784782

Printed On: 1/04/2026

Emergency Situations
Call Unitywater:
1300 086 489

This information on this plan is valid
for 30 days from "Printed On" date.

Legend	
	Extent of Unitywater Area
Water	
	Water Pump Station
	Water Service
	Water Valve
	Water Pipe (Abandoned)
	Water Hydrant
	Water Fitting
Water Main	
	Trunk Main
	Reticulation Main
Sewer	
	Sewer Pump Station
	Sewer Maintenance Hole
	Sewer Valve
	Sewer Fitting
Sewer Gravity Main	
	Trunk Main
	Reticulation Main
	Overflow Main
	Sewer Pipe (Abandoned)
Sewer Pressure Main	
	Pressure Sewer
	Rising Main
	Vacuum Main
	Pressure Sewer Service
	Sewer Service
Recycled Water	
	Recycled Water Pump Station
	Recycled Water Valve
	Recycled Water Hydrant
	Recycled Water Fitting
	Recycled Water Pipe (Abandoned)
	Recycled Water Main

Map Tile: 1
Scale: 1:1000
(If printed at 100%
on A3 size paper)



Before You Dig Australia
PO Box 953
Caboolture QLD 4510

Inquiries: 1300 0 Unity (1300 086 489) Email: dbyd@unitywater.com

Disclaimer These Maps are supplied under the following conditions:- Mapping details are supplied from information contained in Unitywater's records which may have been furnished to Unitywater by other persons. Unitywater gives no warranty or guarantee of any kind, expressed, implied, or statutory, to the correctness, currency or accuracy of the map details or the degree of compliance with any standards in this matter. As per the Important Information included in the response to your enquiry, you agree that these Maps are indicative only and will not be relied upon by you for any purpose. Persons making decisions with financial or legal implications must not rely upon the map details shown on this plan for the purpose of determining whether any particular facts or circumstances exist and Unitywater (and its officers and agents) expressly disclaim responsibility and liability for any loss or damage suffered as a result of placing reliance upon this information. You also acknowledge that these Maps are the intellectual property of Unitywater and may not be reproduced or sold on without the written consent of Unitywater.

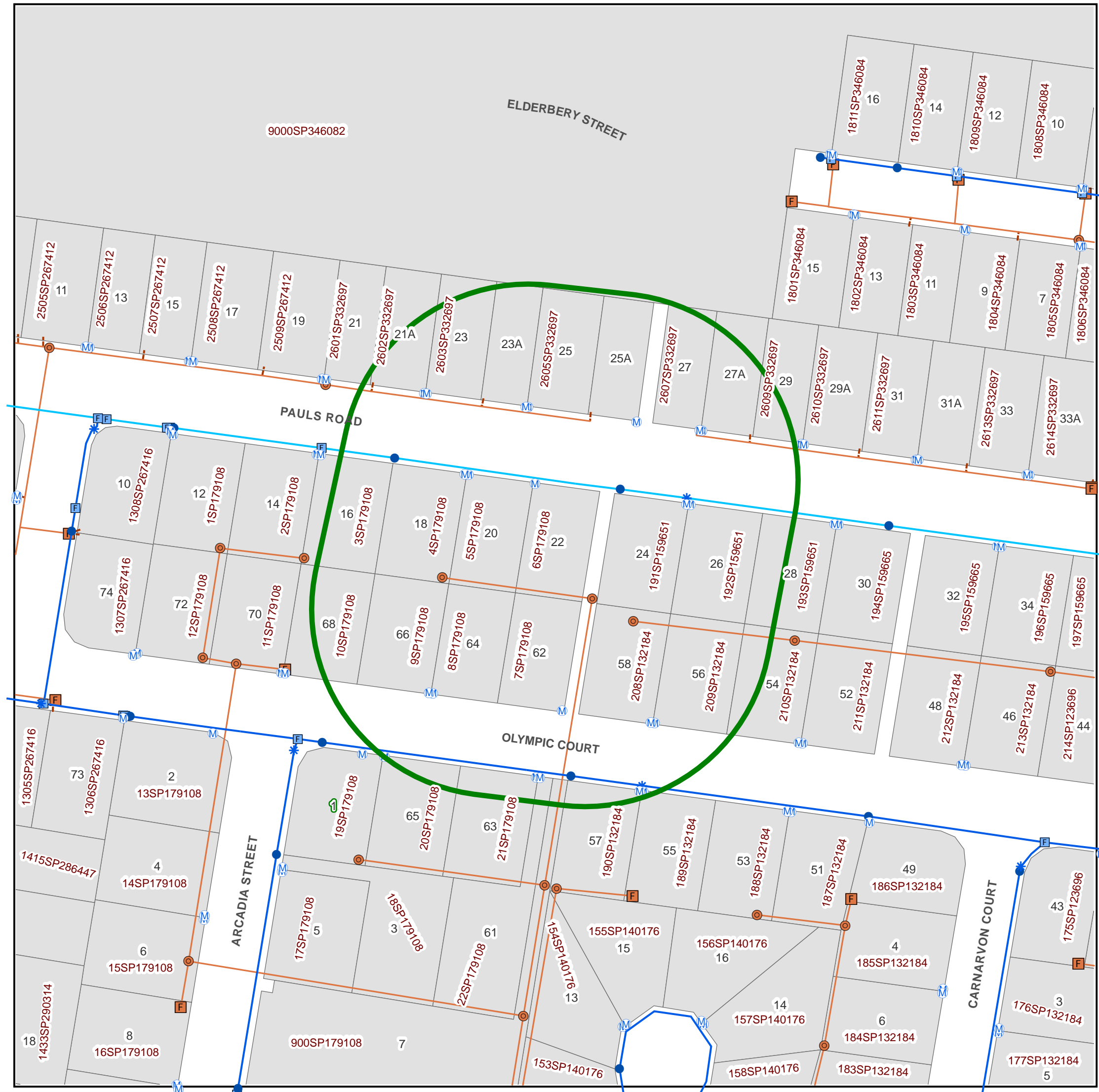

Cable Plan

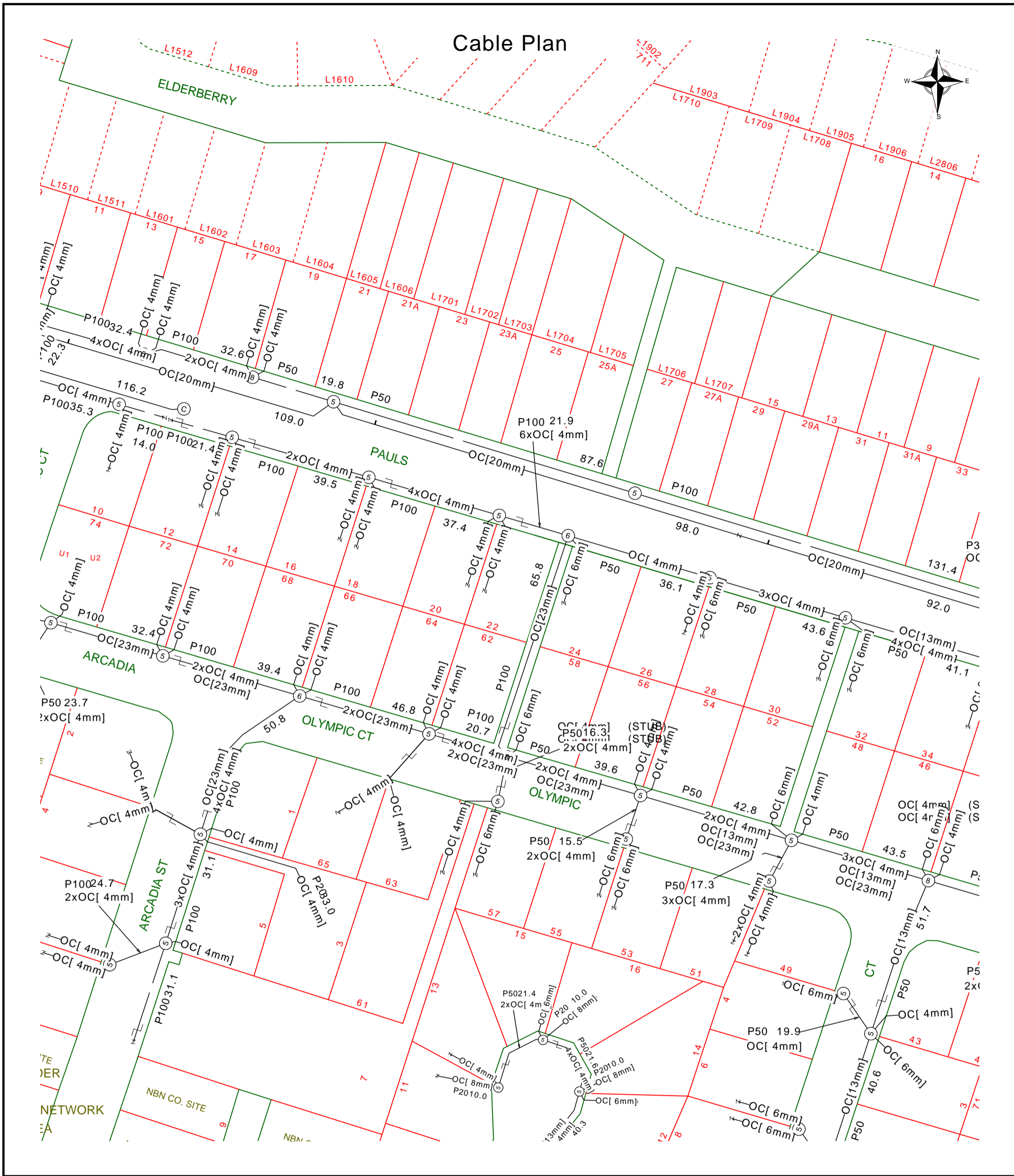
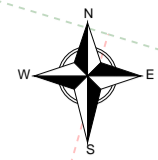

Report Damage: <https://service.telstra.com.au/customer/general/forms/report-damage-to-telstra/>
 Ph - 13 22 03
 Email - Telstra.Plans@team.telstra.com
 Planned Services - ph 1800 653 935 (AEST bus hrs only) General Enquiries

Sequence Number: 270697704

Please read Duty of Care prior to any excavating

TELSTRA LIMITED A.C.N. 086 174 781
 Generated On 01/04/2026 15:56:14

The above plan must be viewed in conjunction with the Mains Cable Plan on the following page

WARNING
 Telstra plans and location information conform to Quality Level "D" of the Australian Standard AS 5488-Classification of Subsurface Utility Information. As such, Telstra supplied location information is indicative only. Spatial accuracy is not applicable to Quality Level D. Refer to AS 5488 for further details. The exact position of Telstra assets can only be validated by physically exposing it. Telstra does not warrant or hold out that its plans are accurate and accepts no responsibility for any inaccuracy. Further on site investigation is required to validate the exact location of Telstra plant prior to commencing construction work. A Certified Locating Organisation is an essential part of the process to validate the exact location of Telstra assets and to ensure the asset is protected during construction works.

See the Steps- Telstra Duty of Care that was provided in the email response.

Mains Cable Plan

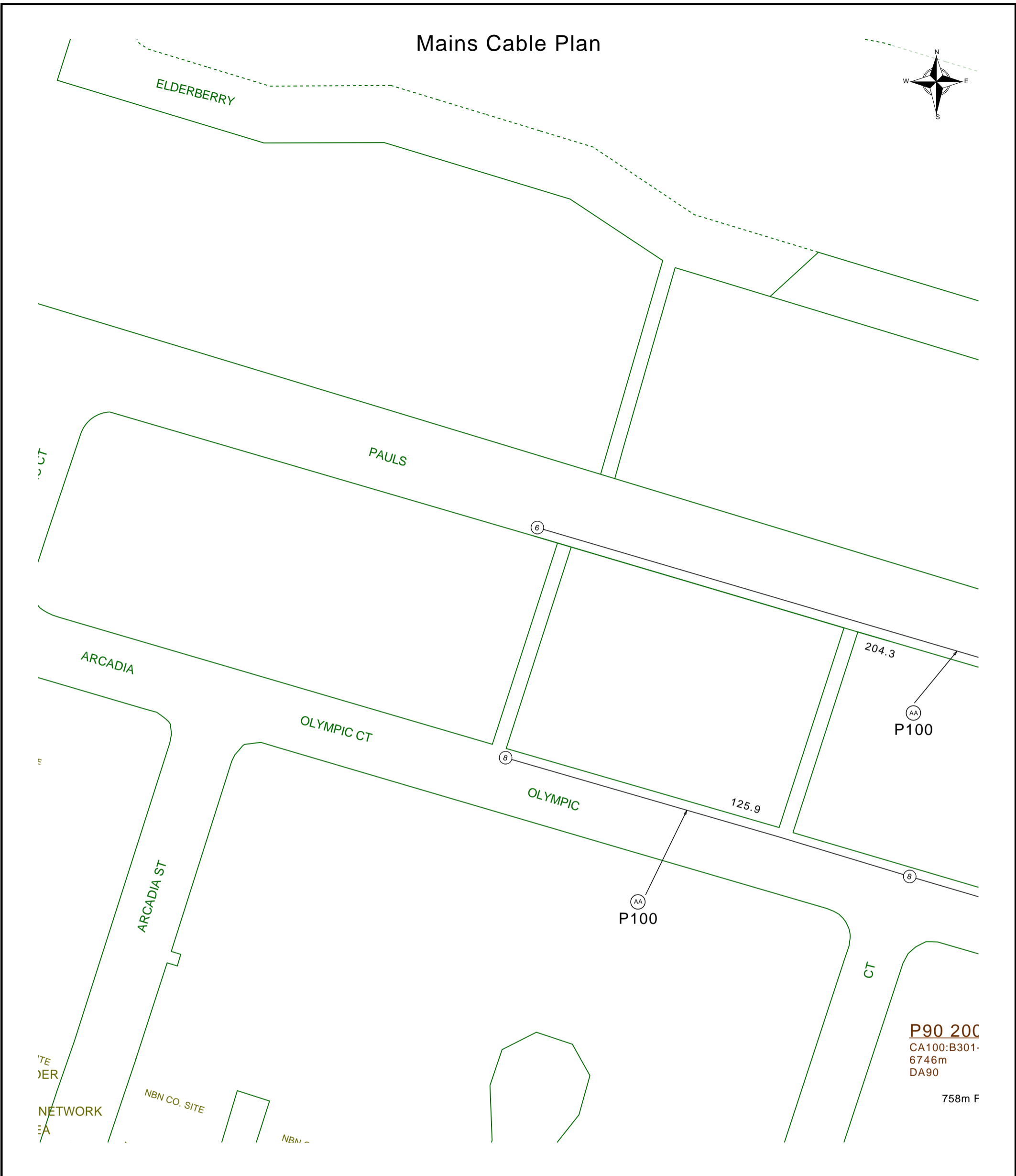
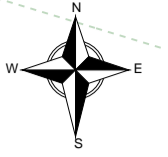

	Report Damage: https://service.telstra.com.au/customer/general/forms/report-damage-to-telstra Ph - 13 22 03 Email - Telstra.Plans@team.telstra.com Planned Services - ph 1800 653 935 (AEST bus hrs only) General Enquiries	Sequence Number: 270697704
	TELSTRA LIMITED A.C.N. 086 174 781 Generated On 01/04/2026 15:56:15	Please read Duty of Care prior to any excavating

The above plan must be viewed in conjunction with the Mains Cable Plan on the following page

WARNING
 Telstra plans and location information conform to Quality Level "D" of the Australian Standard AS 5488-Classification of Subsurface Utility Information. As such, Telstra supplied location information is indicative only. Spatial accuracy is not applicable to Quality Level D. Refer to AS 5488 for further details. The exact position of Telstra assets can only be validated by physically exposing it. Telstra does not warrant or hold out that its plans are accurate and accepts no responsibility for any inaccuracy. Further on site investigation is required to validate the exact location of Telstra plant prior to commencing construction work. A Certified Locating Organisation is an essential part of the process to validate the exact location of Telstra assets and to ensure the asset is protected during construction works.
 See the Steps- Telstra Duty of Care that was provided in the email response.

To: Zenab Khalil
Phone: Not Supplied
Fax: Not Supplied
Email: zenab@kolegal.com.au

Dial before you dig Job #:	52784782	
Sequence #	270697699	
Issue Date:	01/04/2026	
Location:	22 Pauls Road , Upper Caboolture , QLD , 4510	

Indicative Plans are tiled below to demonstrate how to layout and read nbn asset plans

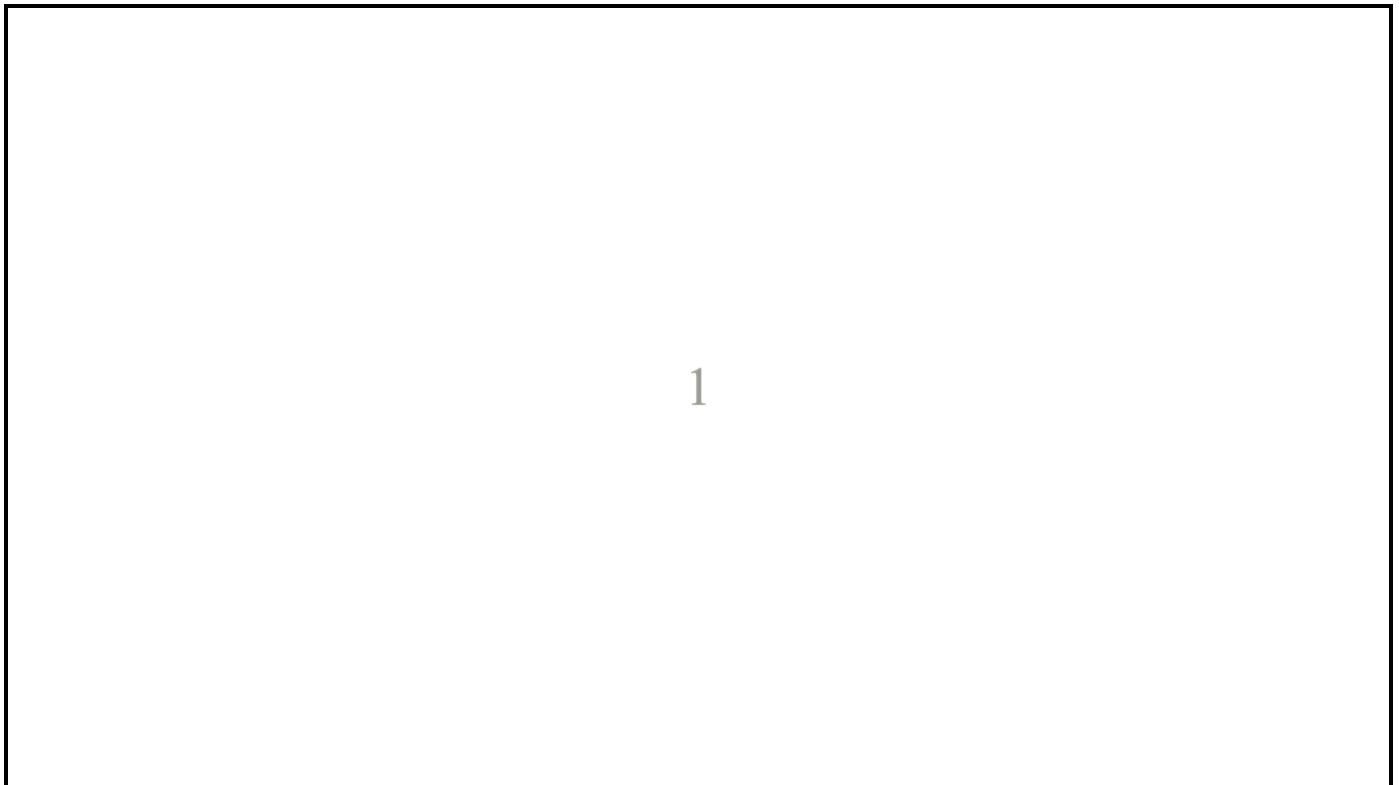



LEGEND



	Parcel and the location
	Pit with size "5"
	Power Pit with size "2E". Valid PIT Size: e.g. 2E, 5E, 6E, 8E, 9E, E, null.
	Manhole
	Pillar
	Cable count of trench is 2. One "Other size" PVC conduit (PO) owned by Telstra (-T-), between pits of sizes, "5" and "9" are 25.0m apart. One 40mm PVC conduit (P40) owned by NBN, between pits of sizes, "5" and "9" are 20.0m apart.
	2 Direct buried cables between pits of sizes, "5" and "9" are 10.0m apart.
	Trench containing any INSERVICE/CONSTRUCTED (Copper/RF/Fibre) cables.
	Trench containing only DESIGNED/PLANNED (Copper/RF/Fibre/Power) cables.
	Trench containing any INSERVICE/CONSTRUCTED (Power) cables.
	Road and the street name "Broadway ST"
Scale	

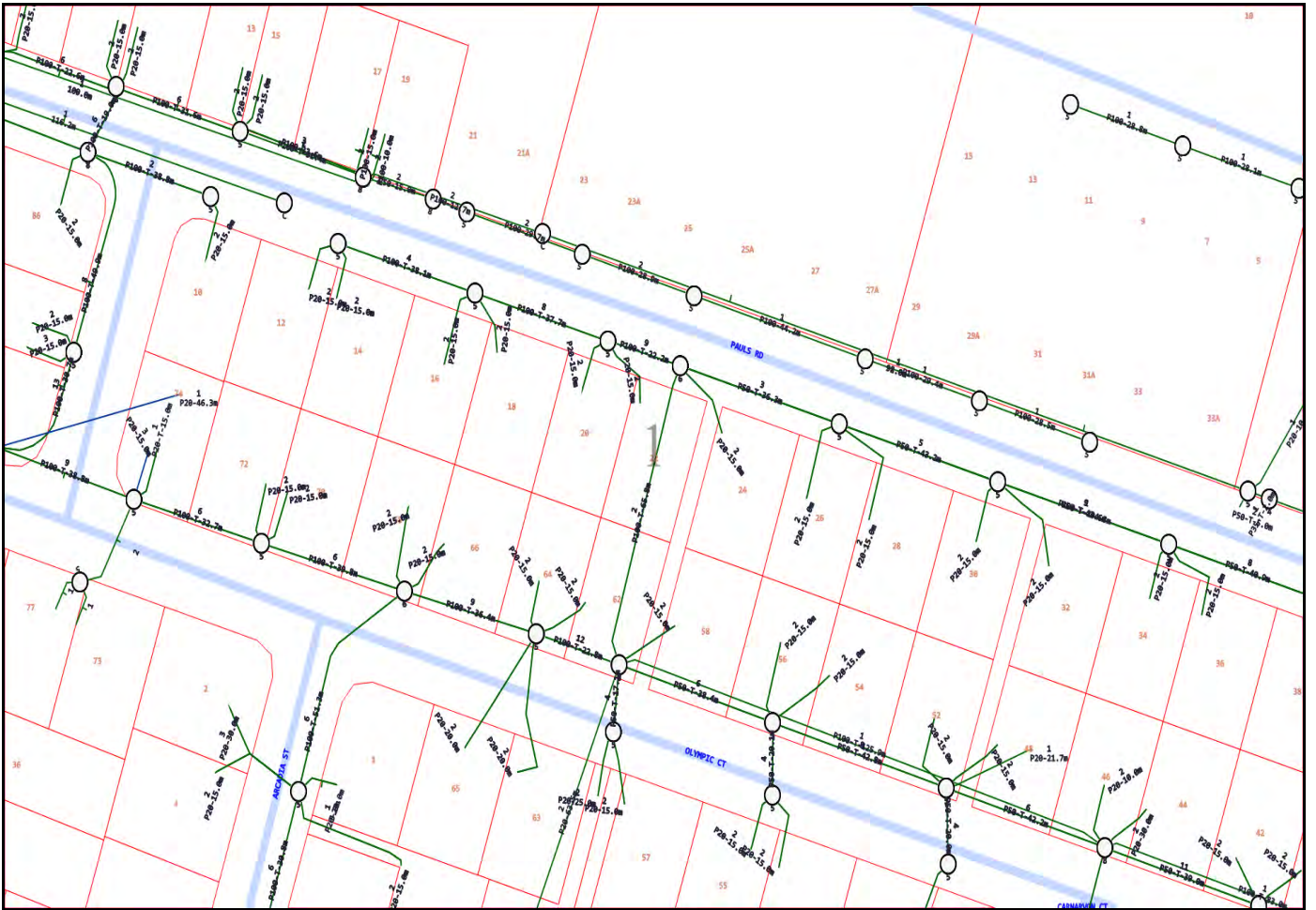

Emergency Contacts

You must immediately report any damage to the **nbn**™ network that you are/become aware of. Notification may be by telephone - 1800 626 329.















BYDA

Sequence: 270697703
Date: 01/04/2026

Scale: 1:1025
Tile No: **OVERVIEW**

CAUTION - HIGH VOLTAGE

LEGEND

-  Substation
-  Cable Marker
-  Pit
-  Pole
-  Pillar
-  LV Cable (up to 1kV)
-  HV Cable (1kV - <33kV)
-  HV Cable (33kV and over)
-  Pit Boundary
-  Planned Work Area

AS5488 Category "D" Plan



DISCLAIMER: While reasonable measures have been taken to ensure the accuracy of the information contained in this plan response, neither Energex nor Pelican Corp shall have any liability whatsoever in relation to any loss, damage, cost or expense arising from the use of this plan response or the information contained in it or the completeness or accuracy of such information. Use of such information is subject to and constitutes acceptance of these terms.



BYDA

Sequence: 270697703
Date: 01/04/2026

Scale: 1:500
Tile No: **Tile No: 1**

CAUTION - HIGH VOLTAGE

LEGEND

- Substation
- Cable Marker
- Pit
- Pole
- Pillar
- LV Cable (up to 1kV)
- HV Cable (1kV - <33kV)
- HV Cable (33kV and over)
- Pit Boundary
- Planned Work Area

AS5488 Category "D" Plan



DISCLAIMER: While reasonable measures have been taken to ensure the accuracy of the information contained in this plan response, neither Energex nor Pelican Corp shall have any liability whatsoever in relation to any loss, damage, cost or expense arising from the use of this plan response or the information contained in it or the completeness or accuracy of such information. Use of such information is subject to and constitutes acceptance of these terms.

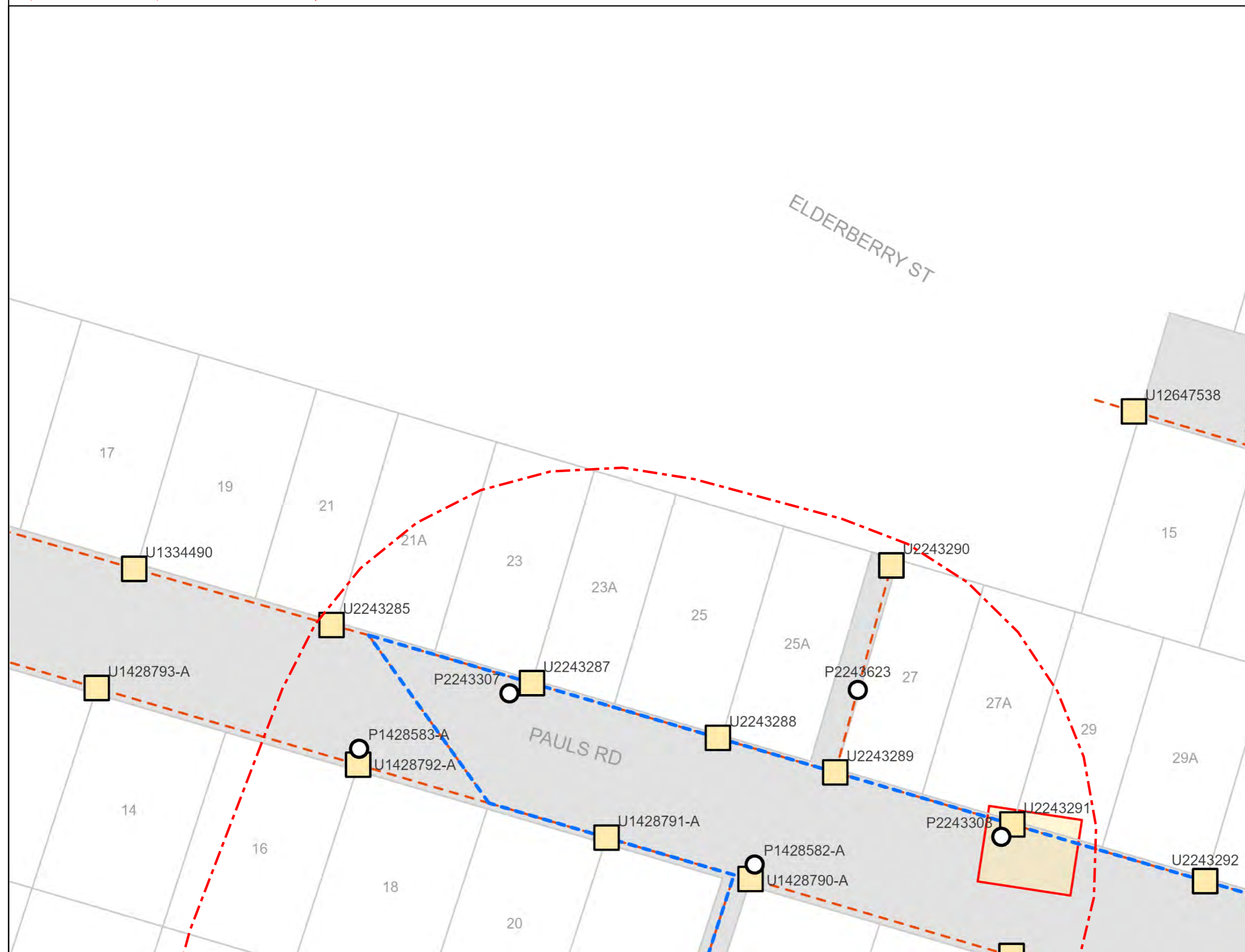



BYDA

Sequence: 270697703
Date: 01/04/2026

Scale: 1:500
Tile No: **Tile No: 2**

CAUTION - HIGH VOLTAGE

LEGEND

- Substation
- Cable Marker
- Pit
- Pole
- Pillar
- LV Cable (up to 1kV)
- HV Cable (1kV - <33kV)
- HV Cable (33kV and over)
- Pit Boundary
- Planned Work Area

AS5488 Category "D" Plan



DISCLAIMER: While reasonable measures have been taken to ensure the accuracy of the information contained in this plan response, neither Energex nor Pelican Corp shall have any liability whatsoever in relation to any loss, damage, cost or expense arising from the use of this plan response or the information contained in it or the completeness or accuracy of such information. Use of such information is subject to and constitutes acceptance of these terms.

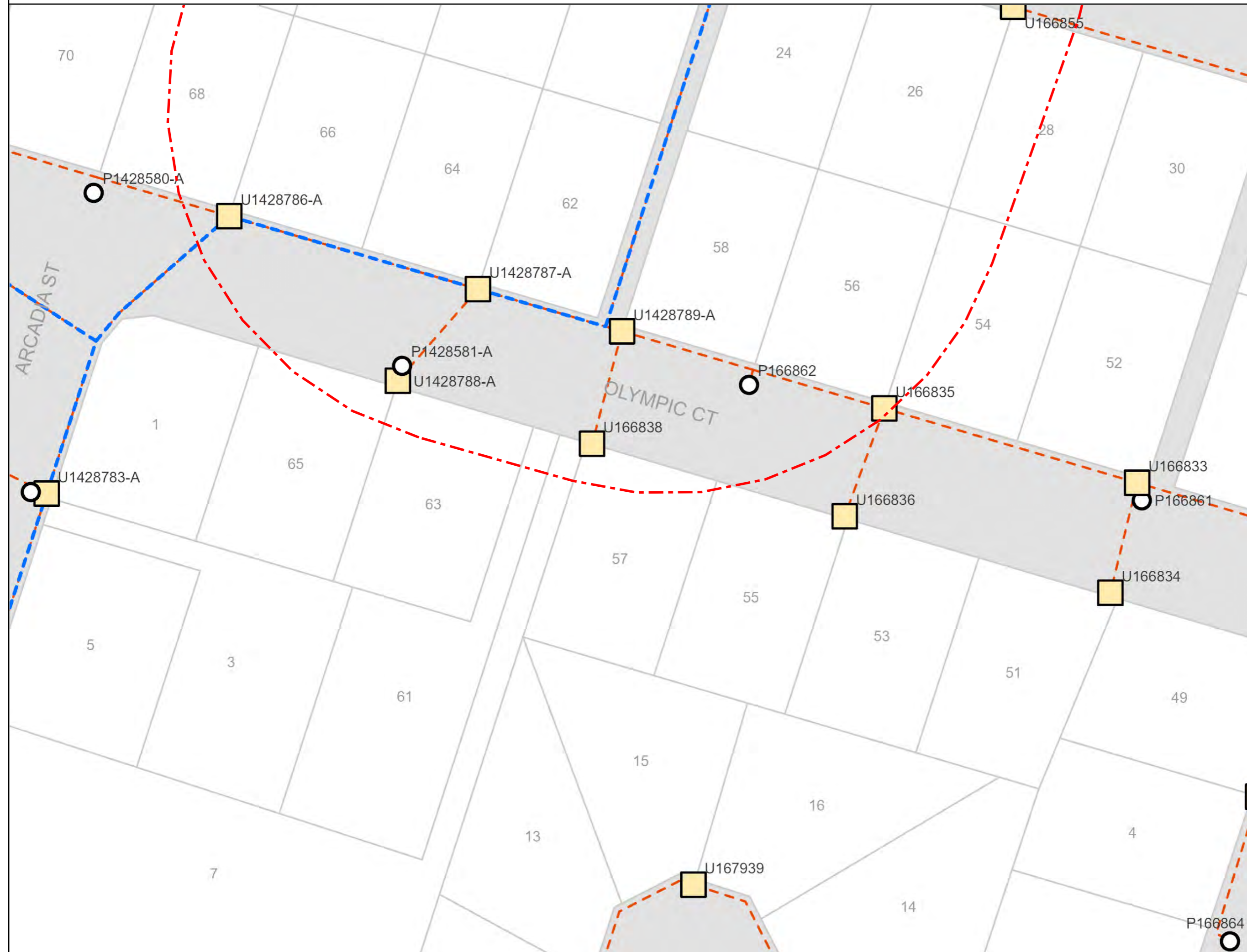

Before You Dig Checklist



1. Plan

- Review maps provided with this BYDA response and confirm the location of your work site is correct.
-



2. Prepare

- Electronically locate gas assets and mark locations.
 - Note: Look for visible evidence of gas assets at the worksite which may not be shown on plans.
-



3. Pothole

- Not applicable where no gas assets present.
-



4. Protect

- Not applicable where no gas assets present.
-



5. Proceed

- Only proceed with your work once you are confident no gas assets are located in vicinity to your work location.
 - APA BYDA response (including maps) are on site for reference at all times, and less than 30 days old.
-

Contacts

Contacts APA Group	
Enquiry	Contact Numbers
General enquiries or feedback regarding this information or gas assets.	APA – Before You Dig Officer Phone: 1800 085 628 Email: BYDA_APA@apa.com.au
Gas Emergencies	Phone: 1800 GAS LEAK (1800 427 532)

Site Watch

Site Watch is where an APA field officer attends your work site to monitor and ensure controls are in place to protect critical gas assets from damage during work.

The following rates* apply for this service (1 hour minimum charge):

Item	Rate (excl. gst)
Site Watch – Business Hours	\$143.42 per hour
Site Watch – After Hours	\$175.06 per hour
Cancellation Fee	\$286.84
<i>Fee applies where cancellations received after 12pm (midday), 1 business day prior to the booking</i>	

Contact APA – Before You Dig officer for state specific hours of business.

**The specified rates do not apply to Origin Energy LPG assets. All charges and invoicing related to these assets will be administered directly by Origin Energy. For further information contact Origin Energy.*

Site 22 Pauls Road
Address: Upper Caboolture
QLD 4510

Sequence 270697702
Number:

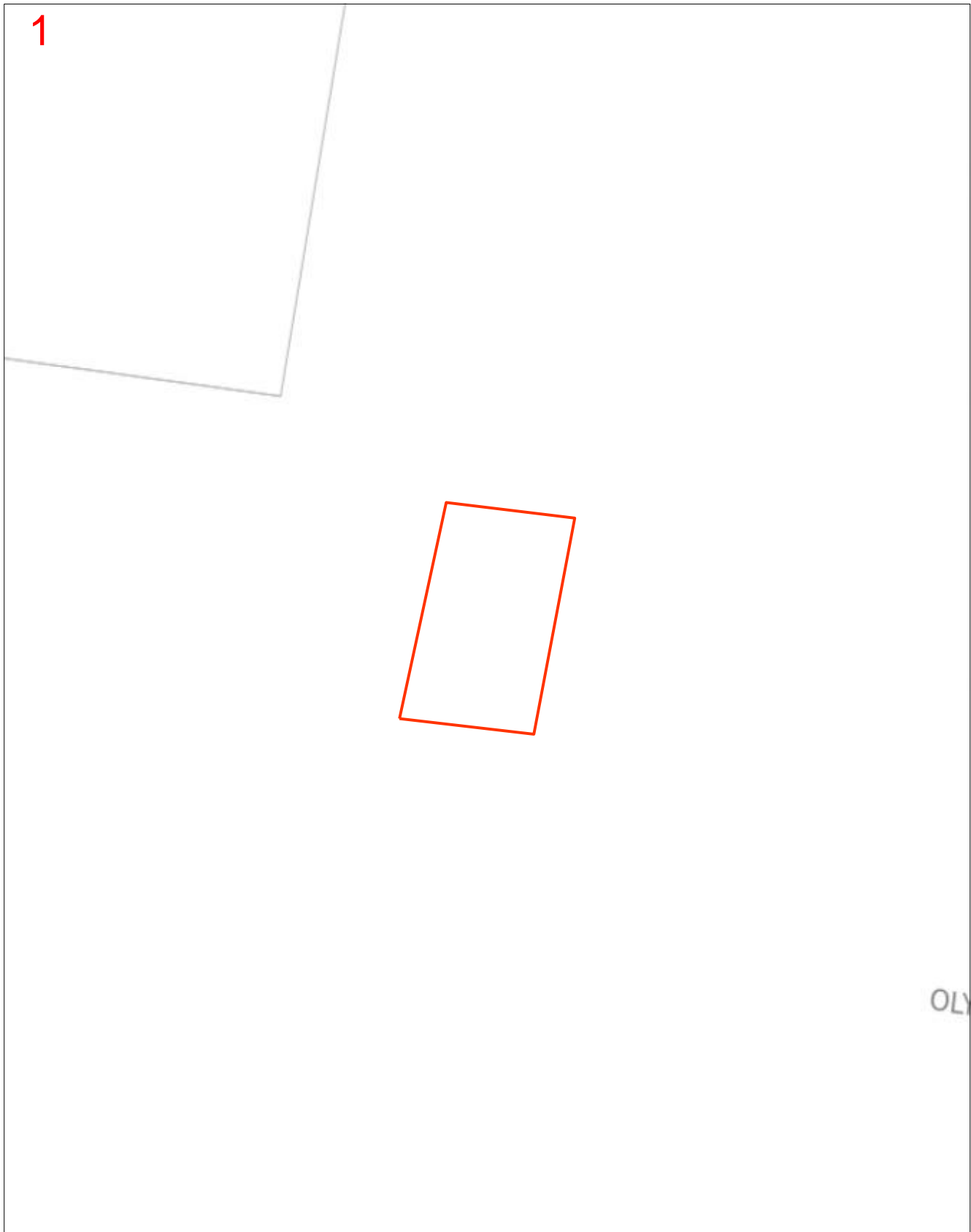

Scale 1: 700

Map Sources: Esri, Garmin, HERE, FAO, NOAA, USGS,
© OpenStreetMap contributors, and the GIS User Community



Enquiry Area



Map Key Area



Legend

PIPE LEGEND: GAS TYPE AND PRESSURE

	Low pressure	Medium pressure	High pressure	Transmission
Natural gas				
Natural gas – proposed				
LPG (yellow dash)	<i>not applicable</i>			<i>not applicable</i>
Hydrogen blended (aqua dash)	<i>not applicable</i>			<i>not applicable</i>

PIPE LEGEND: SPECIAL DESIGNATION

	Low pressure	Medium pressure	High pressure	Transmission
Critical main (yellow highlight)				
Casing (grey highlight)				<i>not applicable</i>

These designations typically apply to any pipe type and pressure

PIPE LEGEND: OTHER STATUS

Abandoned pipe	
Idle or inactive pipe	

ABBREVIATION

BoK	Back of kerb	FoK	Front of kerb
C	Depth of cover	NTI	Not tied in
CP	Cathodic protection		

OBJECT SYMBOLS

Valve		CP test station		Syphon	
Buried valve		CP anode		Marker	
Regulator station		CP bond wire		Part service ^A	
Gas connected property		CP rectifier terminal		^A A live gas service terminated underground within the property boundary, available for future extension to the gas meter.	

PIPE CODE AND MATERIAL

P*	Polyethylene (PE)	CU	Copper
P3	Polyvinyl chloride (PVC)	N2	Nylon
S*	Steel	W2	Wrought galv iron
C*	Cast iron	W3	PE coat wrought galv iron

INTERPRETATION EXAMPLE

40P6 in 80C2	High pressure, 40 mm polyethylene in an 80 mm cast iron casing
63S8	Medium pressure, 63 mm steel

Pipe diameter in millimetres is shown before pipe code.
40P6 = 40 mm nominal diameter

This map was created in colour and should be printed in colour

Important information

- Refer to requirements relating to construction, excavation and other work activities in the **APA Guidelines for Works Near Existing Gas Assets** document with this BYDA response.
- BYDA enquiries are valid for 30 days. If your works commence after 30 days from the date of this response a new enquiry is required to validate location information.
- **For some BYDA enquiries, you may receive two (2) responses from APA. Please read both responses carefully as they relate to different assets.**
- Gas (inlet) services connecting Gas Assets in the street to the gas meter on the property are not marked on the map. South Australia Only – if a meter box is installed on the property, a sketch of the gas service location may be found inside the gas meter box. APA does not guarantee the accuracy or completeness of these sketches.

Free Gas Pipeline Awareness Training and Information

PROFESSIONALS

APA offers online and in-person toolbox forums to support safe work near underground gas assets. Topics include distribution and transmission pipelines, the permit process, and gas emergencies, with content suited for companies of all sizes. A Continuing Professional Development certificate is available upon completion.

Scan the QR code to register for an online toolbox, or email damageprevention@apa.com.au to request an in-person presentation.

HOMEOWNERS

If you're working near your home's gas pipes stay safe and view APA's video guide '**Working Safely Near Gas Lines: A DIY Homeowner's Guide**' which offers simple tips to avoid damaging gas pipes.

Scan the QR code to view the video, or for more information email damageprevention@apa.com.au



Disclaimer and legal details

- This information is valid for 30 days from the date of this response.
- This information has been generated by an automated system based on the area highlighted in your BYDA request and has not been independently verified.
- Map location information is provided as AS5488-2022 Quality Level D, as such supplied location information is indicative only.
- Whilst APA has taken reasonable steps to ensure that the information supplied is accurate, the information is provided strictly on the condition that no assurance, representation, warranty or guarantee (express or implied) is given by APA in relation to the information (including without limitation quality, accuracy, reliability, completeness, currency, sustainability, or suitability for any particular purpose) except that the information has been disclosed in good faith.
- Any party who undertakes activities in the vicinity of APA operated assets has a legal duty of care that must be observed. This legal obligation requires all parties to adhere to a standard of reasonable care while performing any acts that could foreseeably harm these assets

EEOPS FORM 05 Smoke Alarm Installation Record Form

AGENT / OWNER DETAILS:
Name: Jon Mitchell

Installation Address: 22 Pauls Road, Upper Caboolture

Job Number: #0036

New or Existing	Location	Brand / Model	Manufactured Date	Power Source	Interconnection Method
Existing	Bed 1	Google / AO125	Jul 2022	240	Wired
Existing	Bed 2	Google / AO125	Jul 2022	240	Wired
Existing	Bed 3	Google / AO125	Jul 2022	240	Wired
Existing	Hall 1	Google / AO125	Jul 2022	240	Wired

Additional Notes:

Alarms are photoelectric and interconnected as required in the standards below.

We certify that all smoke alarms and auxiliary equipment are installed and tested to the Wiring Rules, Electrical Safety Regulations, and the manufacturer's installation instructions and to the extent it is affected by the electrical work, has been tested and is electrically safe. The installation methods and equipment selection are compliant to Australian standards. They are positioned and interconnected as per the requirements of the Queensland Fire and Emergency Services Act 1990, AS 3786: 2014, Building Regulation 2006 and Building Fire Safety Regulation 2008.

Installer Name: Ehlertth Electrical Inspection Date: 17/3/2026

Contractor Licence Number: 82344

EEOPS FORM 05 - Compliance Cert. .docx	EEOPS Form	Issue date: December 2021	Next Review: December 2023	Version: 1.0
	Printed documents may not be current. Ensure currency prior to use.		Authorised by: Brent Ehlertth	Page 1 of 2

MAINTENANCE FOR LANDLORDS

If you are a landlord you are required to maintain your smoke alarms in working order, and ensure they are less than 10 years old. We recommend the following maintenance routine:

- Check the alarm(s) are firmly secured in the correct location as stated in the Building Code of Australia requirements. (Double sided tape is not acceptable)
- Check the required power source is connected and operating. Where mains powered smoke alarms are installed, they will have a green visual display / light to indicate that mains power is connected. This should be easily seen when standing beneath the alarm.
- Test the smoke alarm during routine inspections, or at least every six months.
- Check the smoke alarm(s) for a build-up of dust and cobwebs.
- Use a surface insect spray around the smoke alarm to prevent insects nesting inside. (Do not spray directly onto the smoke alarm)

- Check the smoke alarms are within their service life. Smoke alarms require replacement every 10 years. The date for replacement is often located on the unit.
- Replace batteries yearly (where the smoke alarm has a user-replaceable 9V battery) – always refer to the manufacturer’s guide when selecting batteries and follow testing procedures.
- Clean with a vacuum cleaner (at least once a year) to remove particles that will affect smoke alarm performance.
- We recommend you undertake this maintenance routine at EACH inspection. Landlords and property managers should keep records of maintenance. A licensed electrical contractor is required to disconnect or install mains powered smoke alarms. All other smoke alarm maintenance does not require a licensed electrical contractor.

MAINTENANCE FOR TENANTS

You do not need to be qualified or licenced

to clean or test a domestic smoke alarm in your Domestic Property.

- Test the alarm monthly by holding down the test button until you hear a loud alert tone, then release. Use a broom handle if you cannot reach but be careful you do not damage the smoke alarm.
- Do not tamper with alarms or place any obstruction to restrict airflow to the alarms, including paint or tape.

- Check the green visual display light is lit up. This shows that the smoke alarm is connected to the mains power.
- Check the smoke alarm(s) for a build-up of dust and cobwebs.
- Vacuum around the smoke alarm vents with a soft brush at least every 6 months.
- If a smoke alarm has failed or not working correctly, contact your real estate agent or landlord as soon as practical.

EEOPS FORM 05 - Compliance Cert. .docx	EEOPS Form	Issue date: December 2021	Next Review: December 2023	Version: 1.0
	Printed documents may not be current. Ensure currency prior to use.		Authorised by: Brent Ehlerth	Page 2 of 2

Rate notice

Customer Service Centres
Caboolture - 2 Hasking Street, Caboolture
Redcliffe - 1 Irene Street, Redcliffe
Strathpine - 220 Gympie Road, Strathpine

Postal Address
PO Box 159
CABOOLTURE QLD 4510

Customer Service
Ph: 1300 522 192

ABN: 92 967 232 136
www.moretonbay.qld.gov.au

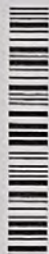

P005MBCRAT20_A4MA07/E-3904/S-4276/I-8551/036

Jonathan J Mitchell
22 Pauls Road
UPPER CABOOLTURE QLD 4510

Rate notice summary

Issue date: 12 January 2026

Your last bill		\$525.65
Payments / adjustments		\$-525.65
	=	
Opening balance		\$0.00
	+	
New rates and charges		\$525.65
	=	
Total due		\$525.65
Due date		11 Feb 2026

This information was prepared on 31 December 2025 for the period 01 January 2026 to 31 March 2026

Property number: 484029

Property location:
22 Pauls Road
UPPER CABOOLTURE QLD 4510

Property description: Lot 6 SP 179108

Valuation: \$295,000

Rating category: General Rate - Category R1 (Single Residential - Owner occupied)

*Paid
11/02*

If you have established a flexible payment plan, your scheduled amount will continue to be debited as arranged.

To view or change an existing flexible payment plan, or to set up a new plan, please visit payble.moretonbay.qld.gov.au

Go paperless!

Receive your rates and reminders via email



Easy

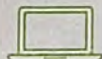

Convenient



Sustainable

A \$2.50 paper notice fee will apply to all quarterly rate notices* received by post.



To register now scan the QR code or visit moretonbay.qld.gov.au/eRates.

*Ratepayers who receive a Council pensioner rebate or self-funded retiree rebate will be exempt from the fee for the rate notice issued for their principal place of residence.

Easy ways to pay



BPAY
Bill code: 339457
Reference number: 50 0484 0290 0484 0297



Post Billpay

Pay in-store at Australia Post



*2471 500484029004840297



PHONE
Call (07) 3480 6349 (Mastercard and Visa only)
Reference number: 50 0484 0290 0484 0297



IN PERSON
Pay at any of Council's Customer Service Centres
Mon to Fri 8.30am - 5pm



ONLINE
Scan the QR code or visit
www.moretonbay.qld.gov.au/pay-your-rates
Reference number: 50 0484 0290 0484 0297



MAIL
Send your payment and remittance slip to:
Moreton Bay City Council
PO Box 159
CABOOLTURE QLD 4510

If you are having difficulty paying, please call Council as soon as possible so we can assist you in setting up a payment plan schedule or visit www.moretonbay.qld.gov.au/rates



Mr J J Mitchell
22 Pauls Rd
UPPER CABOOLTURE QLD 4510

WATER AND SEWERAGE YOUR BILL

1300 086 489
Emergencies and faults 24 Hours, 7 days
Account enquiries 8am-5pm Mon-Fri

unitywater.com
ABN 89 791 717 472

Account number	99885017
Payment reference	0998 8501 76
Property	22 Pauls Rd, UPPER CABOOLTURE, QLD

Bill number	7128478713
Billing period	09 Dec 2025 91 days to 9 Mar 2026
Issue date	13 Mar 2026
Approximate date of next meter reading	5 Jun 2026

Your account activity

Your last bill \$512.39	-	Payments/ adjustments \$512.39	=	Balance \$0.00	+	New charges \$460.00	=	Total due \$460.00
								Due date 14 Apr 2026

8% interest per annum, compounding daily, will apply to any amount not paid by the due date.

Compare your average daily usage over time

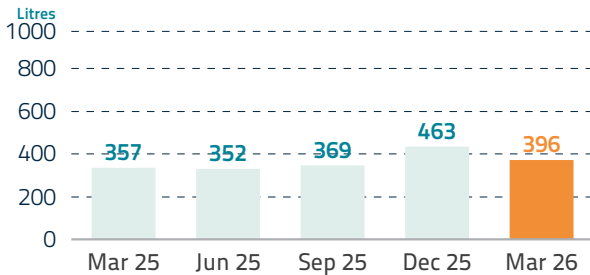

Compare your current daily usage with our regional target of 150 litres

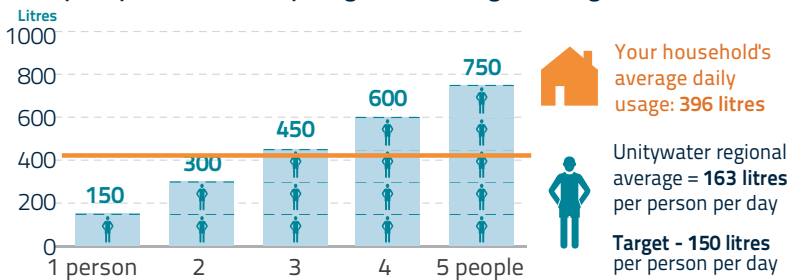

What does *your* water bill pay for?

Your investment in safe and reliable water and wastewater services.

Learn more at unitywater.com/yourwaterbill



Easy ways to pay For other payment options - see over



BPAY®
Billers Code: 130393
Ref: 0998 8501 76
Contact your bank or financial institution to pay from your cheque, savings, debit, credit card or transaction account.
Find out more at bpay.com.au
© Registered to BPAY Pty Ltd ABN 69 079 137 518



Direct Debit
Login to My Account at unitywater.com to set up automatic payments from your bank account or credit card or call us for assistance.

SmoothPay

Smooth out your bill payments across the year with regular fortnightly or monthly payments, interest free.
Find out more at unitywater.com/smoothpay

Your account details



1300 086 489
Account enquiries

8am-5pm Mon-Fri

Water meter details

1 kilolitre (kL) = 1000 litres (L)

Meter ID	Previous read date	Previous reading (kL)	Current read date	Current reading (kL)	Usage (kL)	No. of days	Average daily usage (L)
UT2211879W	8 Dec 25	330	9 Mar 26	366	36	91	395.6
Total water usage					36	91	395.6
Total sewerage usage (waste and greywater) = 90% of water usage					32.40	91	356.0

Activity since last bill

Last bill		\$512.39
Payments / adjustments		
17 Jan 2026	Interest Charges 8% 5 days	\$0.56
18 Jan 2026	BPoint Payment MyAccount	-\$512.95
Account balance		\$0.00

Water and Sewerage Charges

Lot 6 Plan SP179108 Installation ID 78662

State Bulk Water Price	Period	kL/day	x Days	x Price/kL	
State Govt Bulk Water	09 Dec 25 to 09 Mar 26	0.3956	91	\$3.517	\$126.61

This is how much Unitywater pays to purchase water from the State Government, and is passed on to customers at cost.

Unitywater (local government distributor-retailer price)

Variable Usage Charges	Period	kL/day	x Days	x Price/kL	
Water up to 822 L/day	09 Dec 25 to 09 Mar 26	0.3956	91	\$0.787	\$28.33
Sewerage up to 740 L/day	09 Dec 25 to 09 Mar 26	0.3560	91	\$0.787	\$25.50
Fixed Access Charges	Period	x No.	x Days	x Price/day	
Water Access 20mm	09 Dec 25 to 09 Mar 26	1	91	\$1.025	\$93.28
Sewerage Access	09 Dec 25 to 09 Mar 26	1	91	\$2.047	\$186.28

Water subtotal \$248.22
Sewerage subtotal \$211.78

New water and sewerage charges \$460.00

Total Due = ① + ② \$460.00

Important information

Payment assistance

If you are having difficulty paying, please call Unitywater as soon as you receive your bill and before its due date to discuss how we can help.

Changing contact details

Login to My Account at unitywater.com for quick, easy changes online 24/7 or call us during business hours.

Pensioners

If you own and live at your property and have an eligible concession card, you may apply for a pensioner rebate. Please call Unitywater or fill out our easy online form at unitywater.com/pensioner

Credit card payments

Only MasterCard and Visa are accepted. A credit card surcharge may apply to your payment. Learn more at unitywater.com/creditcard

Interest on overdue amounts

Interest of 8% per annum, compounding daily, will apply to any amount not paid by the due date.

Water efficiency

For water efficiency tips, visit unitywater.com/water-tips

Interpreter service 13 14 50

当您需蒙口译员时，请致电 13 14 50
اتصل على الرقم 13 14 50 عندما تكون بحاجة إلى مترجم فوري.
Khi bạn cần thông ngôn, xin gọi số 13 14 50
복역사가 필요하시면 13 14 50 으로 연락하십시오.
Cuando necesite un intérprete llame al 13 14 50

Privacy policy

We've updated our privacy policy so that we can deliver improved services with trusted partners. Visit unitywater.com/privacy

International calls

+ 61 7 5431 8333

unitywater.com

PO Box 953

Caboolture QLD 4510

1300 086 489

More payment options



Credit card by phone or online

To make a one-off credit card (Visa or MasterCard only) payment call 1300 047 763 or go to unitywater.com. A credit card surcharge may apply.
Ref: 0998 8501 76



Cheques by mail

Send this portion with your cheque payable to: Unitywater, Locked Bag 2, Maroochydore BC QLD 4558



In person, by phone or online

Billpay Code: 4028

Ref: 0998 8501 76

Pay in person at any post office, call 13 18 16, or go to postbillpay.com.au



*4028 0998850176 00046000

Account number 99885017

Payment reference 0998 8501 76

Total due **\$460.00**

Due date **14 Apr 2026**







Form 2

Final Audit Report

2026-04-09

Created:	2026-04-09
By:	Zenab Khalil (zenab@kolegal.com.au)
Status:	Signed
Transaction ID:	CBJCHBCAABAA_HhyIKUMl6oxt2WF8Bjo5YBoxFFWYbRY

"Form 2" History

-  Document created by Zenab Khalil (zenab@kolegal.com.au)
2026-04-09 - 6:30:02 AM GMT
-  Document emailed to jono.j.mitchell@gmail.com for signature
2026-04-09 - 6:30:34 AM GMT
-  Email viewed by jono.j.mitchell@gmail.com
2026-04-09 - 6:33:57 AM GMT
-  Signer jono.j.mitchell@gmail.com entered name at signing as Jonathan Jesse Mitchell
2026-04-09 - 6:34:56 AM GMT
-  Document e-signed by Jonathan Jesse Mitchell (jono.j.mitchell@gmail.com)
Signature Date: 2026-04-09 - 6:34:58 AM GMT - Time Source: server
-  Agreement completed.
2026-04-09 - 6:34:58 AM GMT