



Property Report



Prepared by TYSON VON HOFF

36-38 Verdelho Drive Morayfield QLD 4506



0

 Land: 5159m²

House | Plan: SPI78061 | Lot: 47

TYSON VON HOFF
BD Realty

0482 070 660
tyson@bdrealty.com.au





TARGET PROPERTY

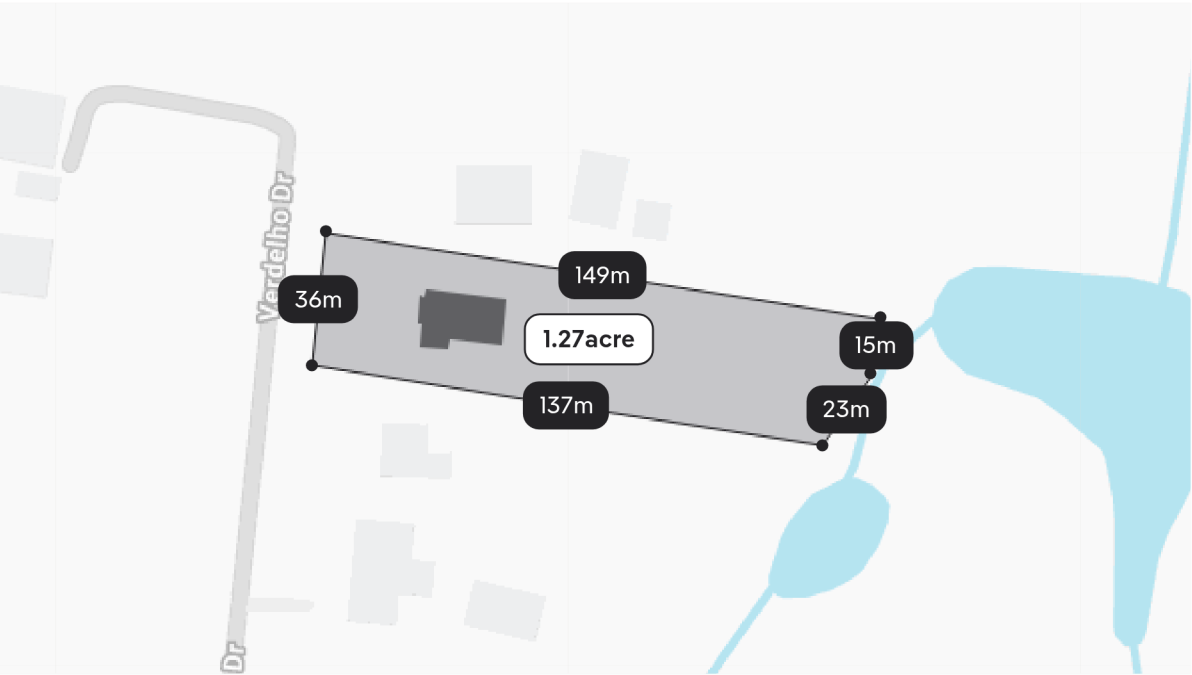

Measurements are estimates only. Data provided under licence from © Geoscape Australia 2022.

Property history

Date	Price	Event Type	Days Listed
21/05/2013	\$218,000	Privately sold	



LEASED PROPERTIES



59 Mackney Rd

Upper Caboolture QLD 4510

4 2 2 Land: 8555m² -

Year built - Distance 1.9km

Property type House

\$995 per week

Last leased 02 Apr 2026

31 days on site



118A Thornbill Drive

Upper Caboolture QLD 4510

5 2 2 Land: 3000m² -

Year built - Distance 1.5km

Property type House

\$895 per week

Last leased 02 Sep 2025

39 days on site



35 Shiraz Chase

Morayfield QLD 4506

4 2 4 Land: 3688m² -

Year built - Distance 1.5km

Property type House

\$900 per week

Last leased 22 Nov 2025

9 days on site



12-16 Bushland Place

Morayfield QLD 4506

4 2 4 Land: 8000m² -

Year built - Distance 1.6km

Property type House

\$900 per week

Last leased 03 Jun 2025

18 days on site



MARKET INSIGHTS - RENTALS

Understanding the current market relating to your property. Sourced by PropTrack and realestate.com.au.

Morayfield market snapshot in the last 12 months

For 0 bed houses in Morayfield. Trend data is calculated based on a rolling twelve month period.

Median rental price

—

Leased volume

—

Price growth

—

Median days on market

—

Median rental price - 3 year trend

Showing the median rental price of 0 bed houses in Morayfield

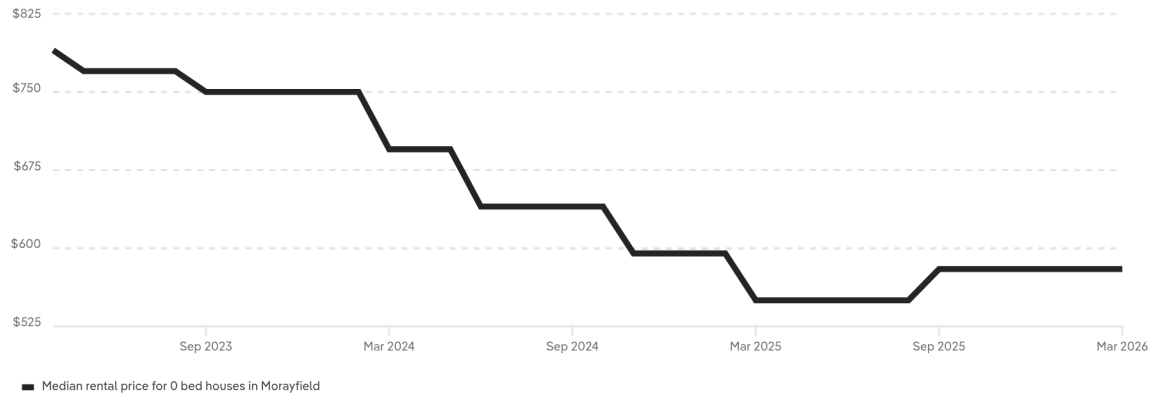

Properties leased - 3 year trend

Showing how many 0 bed houses in Morayfield have leased

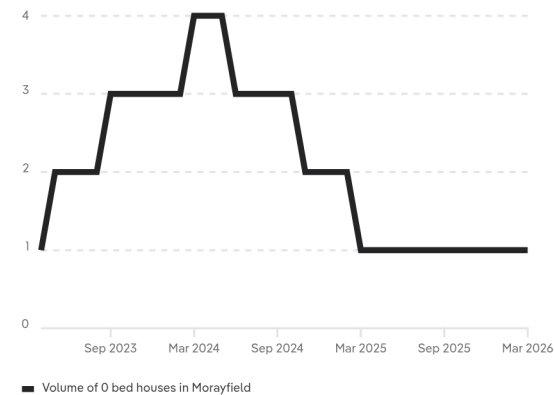

Median days on market - 3 year trend

Showing how long it takes 0 bed houses in Morayfield to lease

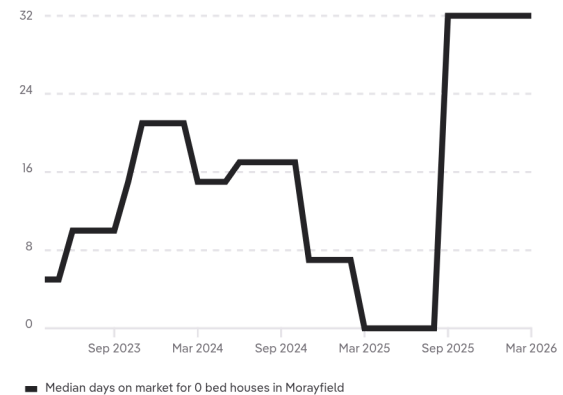



Demand for similar properties

Market activity on realestate.com.au for 0 bed houses in Morayfield

Potential renters

0

Similar for rent

0

Potential renters

Showing the number of people who are seriously interested in listings for 0 bed houses in Morayfield on realestate.com.au

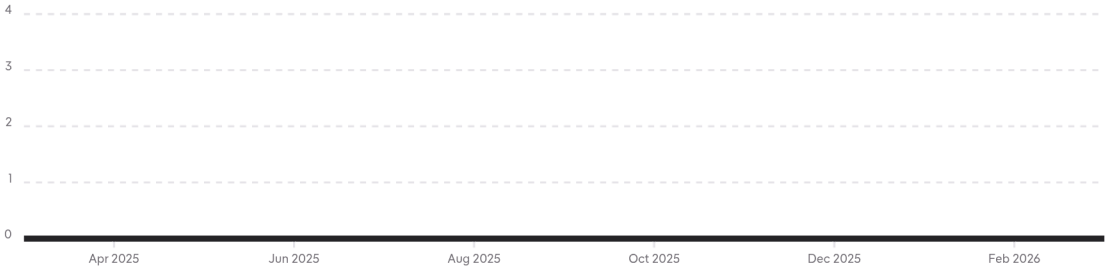

Similar properties for rent

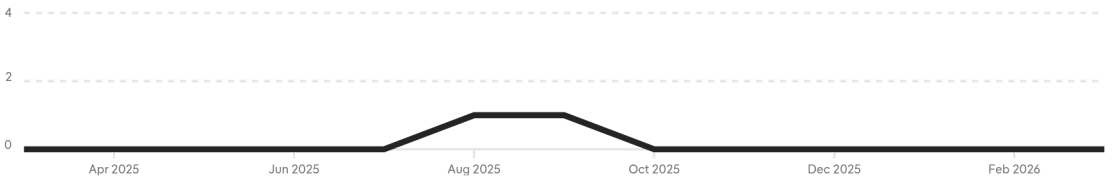

Potential renters calculation - People who have demonstrated serious interest on realestate.com.au with rental listings through a combination of high rent-specific behaviour. Behaviour includes actions like saving a property, sending enquiries, contacting agents or saving inspection times over multiple visits and days. The number of potential renters is determined by aggregating both MyREA members and anonymous users, and takes into account usage of multiple devices by the same user.



APPRAISAL PRICE

36-38 Verdelho Drive

Morayfield QLD 4506

 -  -  0  5159m² | House

\$1000 - \$1100 per week

MY RENTAL ESTIMATE





COPYRIGHT AND LEGAL DISCLAIMERS ABOUT PROPERTY DATA

Some of the information displayed in this document is based on historical and current data supplied to Proptrack Pty Ltd by third parties including State government agencies. Proptrack does not make any warranty as to the accuracy, completeness or reliability of the information or accept any liability arising in any way from any omissions or errors in this information. The information should not be regarded as advice or relied upon by your or any other person and Proptrack recommends that you seek professional advice before making any property decisions.

Queensland Data

Based on or contains data provided by the State of Queensland (Department of Natural Resources and Mines, Manufacturing and Regional and Rural Development) 2025. In consideration of the State permitting use of this data you acknowledge and agree that the State gives no warranty in relation to the data (including accuracy, reliability, completeness, currency or suitability) and accepts no liability (including without limitation, liability in negligence) for any loss, damage or costs (including consequential damage) relating to any use of the data. Data must not be used for direct marketing or be used in breach of the privacy laws; more information at www.propertydatacodeofconduct.com.au

**Leased price refers to the listed rental price when the property was marked as leased on realestate.com.au.

 PropTrack is part of  REA Group